

## PRESTON E HITE AIA NCIDQ

## CURRICULUM VITAE

### ■ OBJECTIVE

To model Christ-honoring and Gospel-bearing character; to provide energetic and visionary leadership; to leverage my experience and skill in design, construction, and technology to help create a better built environment. To build on strong traditions while establishing new and meaningful impacts.

### ■ PROFESSIONAL LICENSE, CERTIFICATION, AND MEMBERSHIP

Registered Architect, State of Alabama, US — Number 5855  
 Certificate, National Council of Architectural Registration Boards — Number 61667  
 Certificate, Council for Interior Design Qualification (NCIDQ) — Number 32045  
 Member, American Institute of Architects, Tennessee Council, Middle Tennessee Chapter

### ■ PORTFOLIO

[www.prestonhite.com](http://www.prestonhite.com)

### ■ PROFESSIONAL EXPERIENCE

**HOAR CONSTRUCTION, NASHVILLE, TENNESSEE — 2024–PRESENT**

**DESIGN & PRE-CONSTRUCTION QUALITY ANALYST;**

**BIRMINGHAM, ALABAMA — 2010–2018**

**PRE-CONSTRUCTION ANALYST (2016–2018), BIM COORDINATOR (2010–2016)**

Large commercial general contractor with offices across the Southeast US.

Apply experience in design, project and data management and in building information modeling (BIM) to enhance firm's overall approach to quality assurance, design support, project coordination, and cost and productivity analysis.

- Created company-wide processes for design review and design support through information-flow planning.
- Led firm-wide BIM strategic planning process, with team members in four states, to create a pathway toward full integration of BIM into firm processes and realization of BIM-based coordination, estimating, scheduling and production control, gaining national recognition.
- Benjamin Russell Hospital for Children, Children's of Alabama, Birmingham, Alabama: New 720,000-sf pediatric hospital expansion facility. Led onsite systems coordination effort.
- University of Virginia Second-year Housing, Charlottesville, Virginia: 776 beds in 329,000-sf on-campus public-private design-build student housing development. Led coordination of structural systems and quality control process during design phase.
- Created Project Item Cost Archive (PICA), a database and application set used by every trade on every project to break down cost according to standardized project items, storing and tracking unit prices and production rates for estimating, billing and scheduling.

**FENG CHIA UNIVERSITY, TAICHUNG CITY, TAIWAN**

**PROFESSOR, SCHOOL OF ARCHITECTURE AND INTERNATIONAL SCHOOL OF TECHNOLOGY AND MANAGEMENT — FEBRUARY 2020–JUNE 2024**

Private research university with enrollment over 20,000.

Joined faculty full-time with desire to encourage and develop students and share expertise.

- Awarded University Social Responsibility Seed Program grants in Spring 2021, Fall 2021, Spring 2022, Fall 2022, and Spring 2023 for student construction service projects.
- Created vision for and began operation of Center for BIM in Education and Industry.
- Taught Theme-oriented Design (graduate studio), Design Management (new class), third-year Interior Design Studio, Working Drawing, Universal Design (new class), fourth-year Architecture Studio, Building Systems, Interior Design Thesis Project, Innovation Project, Practice of BIM, and BIM Parameters and Information Management (new class).

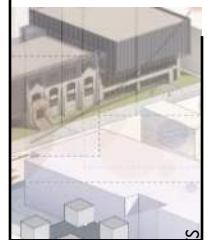

**SAMFORD UNIVERSITY, BIRMINGHAM, ALABAMA****PROFESSOR OF INTERIOR ARCHITECTURE — APRIL–AUGUST 2018****ASSOCIATE PROFESSOR OF INTERIOR ARCHITECTURE — 2013–APRIL 2018****ADJUNCT FACULTY — 2010–2013**

Private, liberal arts university with enrollment over 6,000.

Embraced full-time academic service, desiring to introduce students to the joy of their calling.

- Created a new program, “Design Education for World Impact,” which assigned senior thesis students to a real project to be built in a majority-world country, where they experience the intersection of design and life-change.
- Spearheaded curriculum for new Accelerated Master of Architecture degree program, including NAAB Guideline projections.
- Worked with department faculty on successful reaffirmation of CIDA accreditation.
- Created design drawings, models, and cost estimates for new Interior Architecture department space and new Academy of the Arts and assisted with contract administration.
- Represented School of the Arts in University Faculty Senate (2016–2018).
- Served actively in University Quality Enhancement Plan Committee (2016–2017), and QEP Implementation Committee (2017–2018).
- Participated in Art Faculty Search Committees (2013–2014 and 2017–2018), School of the Arts Curriculum Committee (2015–2018), School of the Arts Catalyst Committee (2015).
- Taught Lighting Design, Shop Craft, Design Fundamentals, Design Communication, Building Systems and Construction Documentation, Design Concepts Studio, Senior Thesis, Portfolio, and History and Theory of Interiors and Furnishings courses.

**TIANJIN INTERNATIONAL SCHOOL, TIANJIN, CHINA — 2009–2010****FINE ARTS TEACHER**

K–12 private school for students holding non-Chinese passports.

Followed a long-time desire to positively impact students, teaching middle school and high school students of multiple nationalities in a variety of arts subjects.

- Led Visual Arts staff through process of curriculum mapping for accreditation review.
- Led AP Studio Art course, guiding students in creation of Advanced Placement portfolios.
- Taught High School Survey of Art History and Sixth-grade Introduction to Art.
- Directed Middle School Advanced Band

**APPLESEED (NOW “CREATURE”), BIRMINGHAM, ALABAMA — 2007–2009****CO-FOUNDING PRINCIPAL**

Values-driven design-build firm with urban-renewal project focus.

Co-founded firm with belief in the importance of design-guided design-build practice.

- Authored organizational vision for the company, consisting of an architecture firm and a design-driven construction firm, able to collaborate or work.
- Oversaw all document creation; authored all project manuals and technical specifications.
- Authored and negotiated client contracts and negotiated consultant contracts.

Projects included:

- Changed Lives Christian Center, Birmingham, Alabama: 35,000-sf housing and employment facility for formerly homeless men. Master planning, design, and managing regulatory process, including two speeches before Birmingham City Council.
- Edgewood Creamery, Birmingham, Alabama: street-front ice cream shop in walkable neighborhood. Constructed for \$34,000, including interior finishes, all custom furniture and millwork, and decor. (Design and construction.) *2008 AIA Alabama Merit Award. 2008 AIA Birmingham Merit Award.*



Work of my students



### **GIATTINA AYCOCK ARCHITECTURE STUDIO, BIRMINGHAM, ALABAMA — 2005–2007 ARCHITECT**

Progressive and acclaimed medium-sized architecture, interiors and planning firm.

Firm advancement activities included:

- In-house software and printing specialist, including investigations of BIM migration process.
- Graphic & copy editing for firm portfolio, writing for project proposals, and coordination for new firm website, GAstudio.com.

Projects included:

- Kia Motors Manufacturing of North America Training Center, West Point, Georgia: 70,000-sf industrial and administrative training facility combining Korean and Southern American typologies; fast-track design-build. Project Manager. *2008 AIA Alabama Honor Award. 2008 AIA Birmingham Honor Award.*
- The Children's Hospital of Alabama, Birmingham, Alabama: Multiple projects, including Neonatal Intensive Care Step-down Unit and Emergency Department Renovations.
- Bank of Tuscaloosa Plaza, Tuscaloosa, Alabama: 100,000-sf Class-A office building overlooking the Black Warrior River in Downtown area.

### **SHERLOCK, SMITH & ADAMS, BIRMINGHAM, ALABAMA — 1999–2004 ARCHITECTURAL INTERN**

Medium-sized integrated multi-discipline architecture and engineering firm.

Firm advancement activities included:

- Complete design, programming, writing and implementation of firm website.

Projects included:

- United States Courthouse, Mobile, Alabama: Associate Architect with Moshe Safdie and Associates for new 320,000-sf facility (unbuilt).
- University of Alabama at Birmingham, School of Nursing Renovations: Worked with University's Design-Build Services Department to renovate ground floor in three phases.
- Wylam Elementary School, Birmingham, Alabama: Renovation and major addition of historic school building (unbuilt).
- Redstone Village Luxury Retirement Community, Huntsville, Alabama: 290,000-sf multiple-care-level main facility and outlying independent living cottages.

### **■ INVITED PRESENTATIONS**

- Hazelip, F. & Hite, P. "Creating Processes to Ensure LOD Specifications Work for Target Value Design: How to Estimate While Design Continues" Estimating Technology for Construction Conference 2016. May 24, 2016. San Francisco, California, US.
- Dexter, B., Hite, P. & Wright, A. "Taking the 'I' Seriously: Optimizing Flow With blm Scheduling." AGC-AIA BIMForum. October 10, 2014. Dallas, Texas, US.
- Hite, P., Barton, C. & Watson, W. "Old Promises, New Tools: Improving Healthcare Facility Delivery by Removing Unknowns from The Process Using Collaboration and Technology." Health Facilities Institute Annual Symposium. October 28, 2013. Williamsburg, Virginia, US.
- Hite, P., Bradshaw, C., Morgan, T., Walker, S., & Wright, A. "One Path to VDC Leadership." Fridays With Trimble Webinar. August 30, 2013.
- Hite, P. & Wright, A. "Hoar Construction's Road from Software Adoption to Social Integration." AGC-AIA BIMForum. April 25, 2013. Miami, Florida, US.
- Hite, P. & Wright, A. "BIM For Facility Management, A Case Study." AGC-AIA BIMForum. October 10, 2012. Tacoma, Washington, US.





- Hite, P. "Selling Sustainability in A Non-green-minded Market." Mississippi State University. October 19, 2012. Starkville, Mississippi, US.
- Hite, P. "BIM In Design and Construction." Alabama Society of Professional Engineers. April 27, 2012. Birmingham, Alabama, US.

## **VOLUNTEER, COMMUNITY, AND MISSIONARY SERVICE EXPERIENCE**

### **INTERNATIONAL MISSION BOARD, TAIWAN TEAM**

#### **TEAM ASSOCIATE — APRIL 2019–JUNE 2024**

Non-staff missionary working as part of a team in partnership with local Taiwanese churches to spread the Gospel of Jesus Christ among the communities of Central Taiwan.

- Led or aided discipleship efforts, including starting and teaching a weekly youth group, helping to start and lead our city's only weekly children's discipleship program, and initiating or engaging in outreach programs on college campuses.

### **MORRISON ACADEMY, TAICHUNG CITY, TAIWAN**

#### **OWNER'S REPRESENTATIVE — NOVEMBER 2021–APRIL 2025**

Private international school, building a replacement high school and performing arts center.

- Provided guidance for architect and builder for understanding requirements of an American school through plan and model reviews and leading meeting discussions.
- Provided design and construction scheduling insight and project progression planning.

### **GALILEE FAMILY SOCIAL WELFARE FOUNDATION, TAITUNG CITY, TAIWAN**

#### **PROJECT DEVELOPMENT VOLUNTEER — JULY 2018–JANUARY 2020**

Not-for-profit organization supporting families with special needs and in at-risk situations.

Moved with family to Taiwan, volunteering full-time in support of families like mine.

- Created new "Housing Doctors" program with my wife, which works with families to solve physical and accessibility-related concerns with their homes.
- Coordinated and marketed Disability & Ministry in Asia-Pacific Conference, March 15–16, 2019, in Taipei, Taiwan. Four keynote presentations and fifteen breakout sessions with speakers from Taiwan, China, Hong Kong, and the United States, for first annual event.
- Created conceptual design and proposal, and guided development of Camp Sycamore, a training farm and outdoor education camp in the mountains of Beinan Township.

### **LEBANESE SOCIETY FOR EDUCATIONAL AND SOCIAL DEVELOPMENT**

#### **VOLUNTEER ARCHITECTURAL DESIGN TEAM LEADER — MARCH, 2013**

SKILD (Smart Kids with Individual Learning Differences) Elementary School, Beirut, Lebanon:

- Lead Architect for an international group of 11 design professionals who traveled to Beirut to design what will be the first school in the Middle East to practice integration of children with special needs and learning differences alongside typically-developing students.
- Prior to traveling, conducted surveys of special education and therapy professionals both in Lebanon and the United States, and worked remotely with another architect to create the space program for the building and to devise a strategy for adjacencies.

### **SAMARITAN'S PURSE/ENGINEERING MINISTRIES INTERNATIONAL**

#### **VOLUNTEER ARCHITECTURAL DESIGN TEAM MEMBER — FEBRUARY 2012**

ELWA Hospital Replacement — Master Plan, Paynesville, Liberia:

- Architectural team leader for a multi-disciplined international group of designers and medical planners who worked together to create the master plan for a newly constructed regional hospital to replace the original hospital built in 1955, which had been looted and fallen into disrepair following the two Liberian civil wars.



**ALABAMA SCHOOL OF FINE ARTS, BIRMINGHAM, ALABAMA, US  
VOLUNTEER TEACHER — 2008**

Publicly-funded statewide magnet high school for intensive study of the arts, math & sciences.

- Invited by school administrator to create and teach a semester-long course in architectural thinking, to introduce students to the integration of theoretical and practical thinking.
- Final projects creatively developed ideas for utilizing leftover downtown space under freeway for humanitarian and civic purposes, presented to a jury of key civic leaders. Project teams paired one math & science focus student with one arts focus student.

**EDUCATION****MASTER OF ARCHITECTURE****GEORGIA INSTITUTE OF TECHNOLOGY, ATLANTA, GEORGIA, US — 1999–2001**

- Master's Project focused on bicycle transit infrastructure: SGF Prize Finalist, 2001.
- John Judson Roland Fellow
- Participated in Cooperative Education program.

**BACHELOR OF SCIENCE IN ARCHITECTURE WITH HIGH HONORS****GEORGIA INSTITUTE OF TECHNOLOGY, ATLANTA, GEORGIA, US — 1995–1999**

- Studied in Paris, France, full academic year 1998-1999
- Certificates in Industrial & Organizational Psychology and Music Technology
- Drum Major (field conductor) of 300-member Yellow Jacket Marching Band, 1996-1998
- Dean's Scholarship and J.W. Whiteside Memorial Scholarship

